

MADE IN EUROPE



This product has been developed and manufactured using both raw materials and with production in Europe.

Choose quality, save money, and protect the environment.

(UK) User Manual

Master Glide

The **Original** Master Glide



01_20250115_UK



Master Glide Flexi



Master Glide Viking



Master Glide Multi



Master Glide Junior



Master Glide Senior

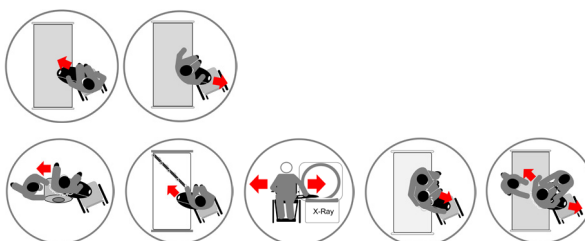

| REF (Article no.) | HMI no. | Name - Size | UDI-DI/GTIN |
|-------------------|---------|-------------------------|----------------|
| MC 001-6000 | 36390 | Master Glide Junior | 05744001971291 |
| MC 001-6010 | 36391 | Master Glide Senior - S | 05744001971307 |
| MC 001-6020 | 36392 | Master Glide Senior - M | 05744001971314 |
| MC 001-7000 | 34160 | Master Glide Flexi - S | 05744001971321 |
| MC 001-7010 | 33246 | Master Glide Flexi - M | 05744001971338 |
| MC 001-7020 | 33247 | Master Glide Flexi - L | 05744001971345 |
| MC 001-7026 | 53378 | Master Glide Multi - M | 05744001971369 |
| MC 001-7027 | 53379 | Master Glide Multi - L | 05744001971376 |
| MC 001-7055 | 122764 | Master Glide Viking - M | 05744001971413 |
| MC 001-7056 | 122765 | Master Glide Viking - L | 05744001971420 |

Regulation MDR 2017/745 for medical devices class 1



ISO 12 31 03 17

The Original Nordic
Human Handling Concept



SCAN ME

Developed &
Manufactured by:



master-care.dk

Thank you for choosing a product from master care A/S.

We recommend reading the user manual thoroughly before using the product (-s).

The information in this user manual applies to the shown products provided that the products have not been modified or customized and that the products have been used as recommended in this user manual.

If the customer changes, repairs or uses the product in other combinations than recommended by master care A/S the CE-approval no longer applies and the guarantee becomes void.

In case of doubt, contact master care A/S or our distributor in your area.

MDR (EU) 2017/745:

Products in this user manual are CE-approved and follows the harmonized standards. This means that the products are in compliance with the essential health and safety directives. The product(-s) comply with the standards in the Medical Device Regulation MDR (EU) 2017/745 – Class 1.

The intended use of the product/-s:

The intended use is to create a bridge between two surfaces during seated or semi-standing transfer between a chair and bed. For users who have difficulty letting go of the surface during transfer due to decreased physical or cognitive functions.

Double leg amputee users should be cautious not to tilt the board during transfer.

Correct use of the product:

The product is placed under the user's buttock. Make sure the product covers the gap between the two support surfaces – equal amount of material on both surfaces is recommended. The anti-skid on the backside must have contact with the support surface.

Contraindication:

If the user does not have sitting balance (truncus stability), another transfer method should be used.

Warning:

Never move over distances that are longer than the maximum distances stated on the product.

Make sure that the user has sufficient support under the bottom and feet, so that the user does not slide off the product.

Risk assessment:

Always make a risk assessment and a functional assessment of the user prior to using the product. This way using the product for transferring or moving a user, is ergonomic and legally sound.

Knowledge of the product/transferring:

It is important that the user of the product has been properly instructed in the use of the product and has read the user manual thoroughly prior to using the product.

master care A/S and our distributors provide education in the use of products and on our website all user manuals can be found.

Life span:

The expected life span of the products with daily wear and tear is averagely 2-5 years. The products life span depends on the use and user's load.

Make visual inspections frequently and preferably before every use. Products with insufficient friction reduction, broken material or other deficiencies must be discarded. This way you will always keep a sound and healthy work environment for both helper and user.

Guarantee:

master care A/S provide a 2-year guarantee covering material defects and manufacturing defects if the product has been used correctly.

Unintended events and injuries when misusing the products:

Unintended events must always be reported to the appropriate National Authority and to master care A/S or the distributor in the current country.

master care A/S and our distributors take no responsibility for personal injuries or product damages if the product(-s) have been used in contravention of the by the manufacturer recommended intended purpose or proper use of the product.



User Manual - Master Glide

Table of Contents

| | |
|---|--------|
| Modelles and functionality: | page 2 |
| Cleaning and reusing the product for new users: | page 2 |
| Transferring between chair and bed - Independent user: | page 2 |
| Transferring between chair and bed - Less independent user, 1 helper: | page 3 |
| Transferring between chair and bed - User with bare or delicate skin: | page 4 |
| Transferring between chair and bed - Dependent user, 2 helpers: | page 4 |
| Guided transferring between bed and chair (Less independent user): | page 4 |
| Technical Specifikations. | page 6 |



User Manual - Master Glide

Modelles and functionality:



1. Master Glide Junior

The small, light, and flexible transfer board for short distances or user's with a high level of mobility.



2. Master Glide Senior

The sliding board that makes room for the wheelchair's tire.



3. Master Glide Flexi

Make this flexible sliding board stiffer by bending up the rear edge prior to a transfer.



4. Master Glide Multi

You can bend both the front and rear edge of this multi-functional sliding board to make it fit around the wheelchair wheel and/or short legs. When bending the edges, the board is made more stable.



5. Master Glide Viking

This sliding board has the same properties as the Master Glide Flexi but is adjusted to users with shorter legs.



6. This product can be cleaned with a water and soap.

After cleaning, the product can be reused by other users.

Make sure the material is not scratched or damaged. If the product is severely abraded or otherwise damaged, it must be discarded.

Transferring between chair and bed - Independent user:



7. Sitting on the edge of the bed the user grabs the middle handle of the Master Glide, leans to the side, and slides the board under the buttock.



8. To avoid sliding bumping into the wheel and to make the board more stable bend up the back edge of the Master Glide.



9. The user leans towards the Master Glide to shift the weight over to the board. Use one hand to keep the upper body stable on the Master Glide while transferring slowly towards the wheelchair.

User Manual - Master Glide



10. With the feet solid on the ground the user leans a bit forward. Use the smooth surface of the Master Glide to slide the buttocks back in the bed repositioning the pelvic correctly.



11. If the user has short legs a Foot Master - PMA-8090 - can be used. This way the thighs are horizontal, and it is easier to transfer the buttocks backwards using the Master Glide.



12. Remove the Master Glide by grabbing the two handles. Pull the Master Glide towards a vertical position and wiggle out the board by pulling it from side to side.

Transferring between chair and bed - Less independent user, 1 helper:



13. The user leans towards the armrest of the wheelchair. The helper slides the Master Glide under the user's buttock.



14. The user places one hand on the Master Glide to keep the balance and pushes with the other hand towards the armrest of the wheelchair or the wheel.



15. To avoid pulling the clothes, to create a sense of security and to obtain the optimal working conditions the helper can use a Master Belt around the user buttocks or lower back.



16. The helper grabs the handles of the Master Belt and supports the user's knees at the same time.



17. Using the Master Glide transfer the user by repeating a series of slow, short, and calm movements. Remember to include the user's resources and encourage the user to participate during the transfer.



18. Remove the Master Glide by leaning the user to the side. The Helper grabs the two handles. Pulls the Master Glide towards a vertical position and wiggles out the board by pulling it forwards and backwards.

User Manual - Master Glide

Transferring between chair and bed - User with bare or delicate skin:



19. The user leans towards the side. Fold a sliding piece – Nylon Master S. Place the Master Glide in the fold and slide both under the user's buttocks. Pull out the Master Glide and place it under the sliding piece.



20. Make sure the user's feet are solid on the ground and that the Master Glide is in a horizontal position. The user can now make the transfer with a minimum of friction while the Master Glide bridges the gap between bed and chair.

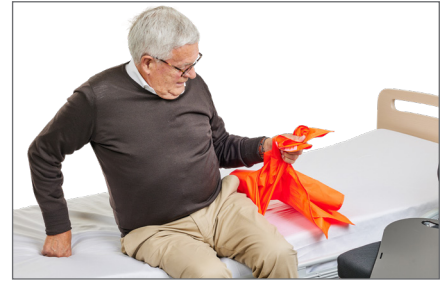

21. Remove the Master Glide. Remove the sliding piece by pulling the lower part from one corner. If you feel resistance pull the opposite lower corner.

Transferring between chair and bed - Dependent user, 2 helpers:



22. Place a Master Belt around the user's lower back. Helper A grabs the handles of the Master Belt and helps the user lean towards the side. Helper B places the Master Glide under the user's buttocks.



23. Standing in front of the user Helper A controls the user's movements forwards and backwards by using the Master Belt. It can be an advantage to support the user's knees. Helper B controls the user's movements to the sides by pulling or pushing the handles of the Master Belt on the user's sides.



24. To remove the Master Glide Helper A helps the user leaning to the side by using the Master Belt. Helper B grabs the two handles of the Master Glide. Pulls it towards a vertical position and wiggles out the board by pulling it forwards and backwards.

Guided transferring between bed and chair (Less independent user):



25. The user leans towards the side. The helper slides the Master Glide under the user's buttock.



26. The helper sits besides the user either on the bed or on the Master Glide/chair. The helper places a hand furthest away on the user's waist/hip.



27. The helper and the user moves simultaneously to the side, a small piece at a time. The helper can facilitate the movement by pulling or pushing lightly on the user's waist/hip. If necessary a helper can facilitate from each side of the user.

Product Quality - Functionality - Quality of Life



User Manual - Master Glide

Technical Specifications

Certifications:

REACH

DODD

BSE/TSE

Materials: Polyethylene

| Article no. - Product Name: | Size: | Max. user weight (SWL): | Max gap between support points: | Package weight: |
|-------------------------------------|------------------------|-------------------------|---------------------------------|-----------------|
| MC 001-6000 Master Glide Junior | L 40 x W 20 x H 0,5 cm | 160 kg | Max 5 cm | 0,40 kg |
| MC 001-6010 Master Glide Senior - S | L 45 x W 35 x H 0,5 cm | 160 kg | Max 20 cm | 0,68 kg |
| MC 001-6020 Master Glide Senior - M | L 60 x W 35 x H 0,5 cm | 160 kg | Max 20 cm | 0,78 kg |
| MC 001-7000 Master Glide Flexi - S | L 40 x W 35 x H 0,5 cm | 160 kg | Max 20 cm | 0,52 kg |
| MC 001-7010 Master Glide Flexi - M | L 60 x W 35 x H 0,5 cm | 160 kg | Max 20 cm | 0,88 kg |
| MC 001-7020 Master Glide Flexi - L | L 75 x W 35 x H 0,5 cm | 160 kg | Max 20 cm | 1,12 kg |
| MC 001-7026 Master Glide Multi - M | L 60 x W 35 x H 0,5 cm | 160 kg | Max 20 cm | 0,84 kg |
| MC 001-7027 Master Glide Multi - L | L 75 x W 35 x H 0,5 cm | 160 kg | Max 20 cm | 1,18 kg |
| MC 001-7055 Master Glide Viking - M | L 60 x W 35 x H 0,5 cm | 160 kg | Max 20 cm | 0,78 kg |
| MC 001-7056 Master Glide Viking - L | L 75 x W 35 x H 0,5 cm | 160 kg | Max 20 cm | 1,02 kg |

WARNINGS



Never leave the user on the product when lying on the edge of the bed.



Never leave the product on the floor.



Check the product for max. distance between the support surfaces.



Make sure that all relevant brakes are activated before transferring the user.



CE-certification:

This product is CE-approved and follows the harmonized standards. This means that the products are in compliance with the essential health and safety directives. The product(-s) comply with the standards in the Medical Device Regulation (EU) 2017/745 – class 1.



Surface cleaning:

The surface of this product can be cleaned with a wet cloth and soap.



Detergents pH level:

This product tolerates detergents / disinfectants with a pH level between 5-9.



Disinfectants:

This product tolerates alcoholic disinfectants with a pH level between 5-9.



Maintenance:

Make visual inspections frequently and preferably before every use. Pay attention to scratches and tears to the surface. Products with high friction or other deficiencies must be discarded.



User Manual:

Always read the User Manual thoroughly before using the product.



Disposal:

Always make sure to follow local guidelines when disposing or discarding the product.

For more information, videos
Quick Guide etc., visit
www.master-care.dk