

MADE IN
EUROPE



This product has been developed and manufactured using both raw materials and with production in Europe.

Choose quality, save money, and protect the environment.

(UK) User Manual

01_20241001_UK

Master Glide Bifrost



Regulation MDR 2017/745 for medical devices class 1



ISO 12 31 03 17

The Original Nordic
Human Handling Concept



SCAN ME

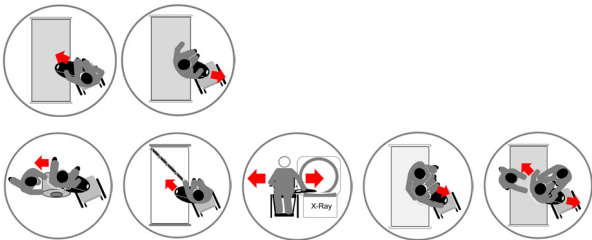

Article no.	HMI no.	Name - Size	UDI-DI/GTIN
MC 001-7030	53192	Master Glide Bifrost - S	5744001971383
MC 001-7035	53193	Master Glide Bifrost - M	5744001971390
MC 001-7040	53194	Master Glide Bifrost - L	5744001971406

Developed &
Manufactured by:



Thank you for choosing a product from master care A/S.

We recommend reading the user manual thoroughly before using the product (-s).

The information in this user manual applies to the shown products provided that the products have not been modified or customized and that the products have been used as recommended in this user manual.

If the customer changes, repairs or uses the product in other combinations than recommended by master care A/S the CE-approval no longer applies and the guarantee becomes void.

In case of doubt, contact master care A/S or our distributor in your area.

MDR (EU) 2017/745:

Products in this user manual are CE-approved and follows the harmonized standards. This means that the products are in compliance with the essential health and safety directives. The product(-s) comply with the standards in the Medical Device Regulation MDR (EU) 2017/745 – Class 1.

The intended use of the product/-s:

The intended use is to create a bridge between two surfaces during seated or semi-standing transfer between a chair and bed. For users who have difficulty letting go of the surface during transfer due to decreased physical or cognitive functions.

Double leg amputee users should be cautious not to tilt the board during transfer.

Correct use of the product:

The product is placed under the user's buttock. Make sure the product covers the gap between the two support surfaces – equal amount of material on both surfaces is recommended. The anti-skid on the backside must have contact with the support surface.

Contraindication/Warning:

If the user does not have sitting balance (truncus stability), another transfer method should be used. Never move over distances that are longer than the maximum distances stated on the product.

Make sure that the user has sufficient support under the bottom and feet, so that the user does not slide off the product.

Risk assessment:

Always make a risk assessment and a functional assessment of the user prior to using the product. This way using the product for transferring or moving a user, is ergonomic and legally sound.

Knowledge of the product/transferring:

It is important that the user of the product has been properly instructed in the use of the product and has read the user manual thoroughly prior to using the product.

master care A/S and our distributors provide education in the use of products and on our website all user manuals can be found.

Life span:

The expected life span of the products with daily wear and tear is averagely 2-5 years. The products life span depends on the use and user's load.

Make visual inspections frequently and preferably before every use. Products with insufficient friction reduction, broken material or other deficiencies must be discarded. This way you will always keep a sound and healthy work environment for both helper and user.

Guarantee:

master care A/S provide a 2-year guarantee covering material defects and manufacturing defects if the product has been used correctly.

Unintended events and injuries when misusing the products:

Unintended events must always be reported to the appropriate National Authority and to master care A/S or the distributor in the current country.

master care A/S and our distributors take no responsibility for personal injuries or product damages if the product(-s) have been used in contravention of the by the manufacturer recommended intended purpose or proper use of the product.



User Manual - Master Glide Bifrost

Table of Contents

Transfer between bed and chair (Independent user):	page 2
Transfer between bed and chair (less active user, one helper):	page 2
Transferring using Master Belt:	page 3
Transfer between chair and bed (User with naked or sensitive skin):	page 3
Transfer between bed and chair (less active user, two helpers):	page 3
Guided transferring between bed and chair (Less independent user):	page 4
Technical Specifications	page 6



User Manual - Master Glide Bifrost

Transfer between bed and chair (Independent user):



1. Place the wheelchair diagonally against the bed. The user is sitting on the edge of the bed with the feet on the floor.



2. The user leans to one side and the Master Glide is placed under the elevated pelvis towards the chair.



3. The user shifts the weight onto the Master Glide and slides towards the chair.



4. Slide all the way over onto the seat of the chair. The user leans slightly forwards and uses the slippery surface of the Master Glide to push the pelvis all the way back in the seat.



5. If the user has short legs or otherwise having trouble reaching the floor, a PMA-8090 Foot Master can be used.



6. The user leans to the side and removes the Master Glide by gripping the handle, wriggling the Master Glide from side to side, and at the same time lifting it upwards thereby freeing the anti-skid from the chair.

Transfer between bed and chair (less active user, one helper):



7. The user leans towards the wheelchair's armrest for support. The helper slides the Master Glide under the pelvis. A bilayered sliding sheet can be used if placing the transfer board is hard.



8. During the transfer the user can support them self using one hand on the Master Glide and the other on the wheelchair's armrest.



9. For security and safe guiding, a MC 003-1126 Master Belt – M, can be fitted around the user's waist.

User Manual - Master Glide Bifrost

Transferring using Master Belt:



10. Fit the Master Belt around the user. The helper grips the Master Belt handles and supports the user's knees at the same time.

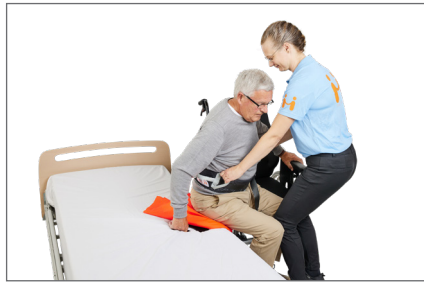

11. Transfer the user in short tugs using the slippery surface of the Bifrost. Remember to involve the user as much as possible.



12. To remove the Bifrost the user leans towards the wheelchair's armrest. The helper grips the handle, wiggles the transfer board from side to side, and at the same time lifts it upwards to free the anti-skid from the chair and pulls it out.

Transfer between chair and bed (User with naked or sensitive skin):



13. The user leans to the side. Place the Bifrost in the fold of a Nylon Master Sliding Material. Slide both under the user's elevated pelvis, pull out the Bifrost and place it under the sliding material.



14. With the feet placed on the floor the user slides easily sideways. Bifrost builds a bridge between the bed and the wheelchair, and the user feels no friction.



15. After the transfer remove the Bifrost. Grip the lower part of the sliding material and pull it out from under the user. This way the sliding material does not pull the user's skin.

Transfer between bed and chair (less active user, two helpers):



16. Fit a Master Belt around the user's waist. Helper A grips the handles and helps the user to lean to the side. Helper B places the Bifrost under the user's elevated pelvis.



17. Helper A stands in front of the user, holding on to the handles of the belt and supporting the user's knees. Make the transfer with small, calm, tugs. Helper B guides the user's pelvis along the surface of the Bifrost either from the front or from the backside.



18. Helper A supports the user in leaning to the side using the handles of the belt, while Helper B grabs the Bifrost, pulls it up and wiggles it out from under the user.

User Manual - Master Glide Bifrost

Guided transferring between bed and chair (Less independent user):



19. The user leans towards the side. The helper slides the Master Glide under the user's buttock.



20. The helper sits besides the user either on the bed or on the Master Glide/chair. The helper places a hand furthest away on the user's waist/hip.



21. The helper and the user moves simultaneously to the side, a short tug at a time. The helper can facilitate the movement by pulling or pushing lightly on the user's waist/hip. If necessary a helper can facilitate from each side of the user.

Product Quality - Functionality - Quality of Life



User Manual - Master Glide Bifrost

Technical Specifications

Certifications:

REACH
DODD
BSE/TSE

Materials: Trespa

Article no. - Product Name:	Size:	Max. user weight (SWL):	Max gap between support points:	Package weight:
MC 001-7030 Master Glide Bifrost - S	L 45 x W 22 x H 0,6 cm	300 kg	Max 5 cm	0,78 kg
MC 001-7035 Master Glide Bifrost - M	L 60 x W 22 x H 0,6 cm	300 kg	Max 20 cm	1,12 kg
MC 001-7040 Master Glide Bifrost - L	L 70 x W 22 x H 0,6 cm	300 kg	Max 40 cm	1,26 kg

WARNINGS



Never leave the user on the product when lying on the edge of the bed.



Never leave the product on the floor.



Check the product for max. distance between the support surfaces.



Make sure that all relevant brakes are activated before transferring the user.



CE-certification:

This product is CE-approved and follows the harmonized standards. This means that the products are in compliance with the essential health and safety directives. The product(-s) comply with the standards in the Medical Device Regulation (EU) 2017/745 – class 1.



Surface cleaning:

The surface of this product can be cleaned with a wet cloth and soap.



Detergents pH level:

This product tolerates detergents / disinfectants with a pH level between 5-9.



Disinfectants:

This product tolerates alcoholic disinfectants with a pH level between 5-9.



Maintenance:

Make visual inspections frequently and preferably before every use. Pay attention to scratches and tears to the surface. Products with high friction or other deficiencies must be discarded.



User Manual:

Always read the User Manual thoroughly before using the product.



Disposal:

Always make sure to follow local guidelines when disposing or discarding the product.

For more information, videos
Quick Guide etc., visit
www.master-care.dk

